

Discos Sólidos – Espessura 20 mm e 30 mm / Dimensões e Dados Técnicos

Solid Discs - 20 and 30 mm Thickness / Dimensions and Technical Data

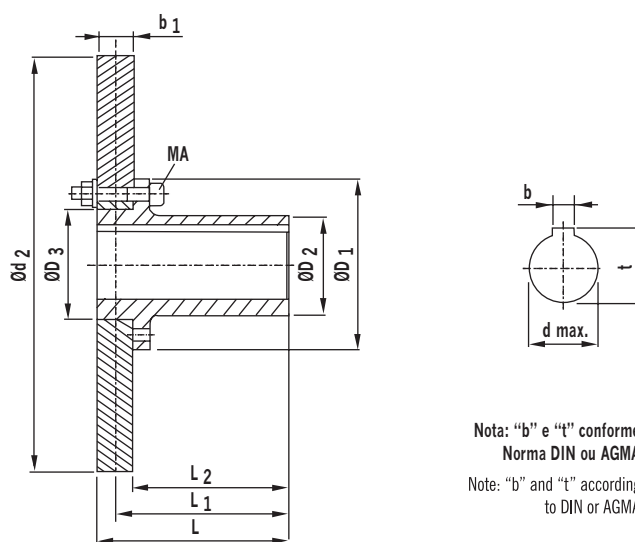

Tamanhos / Sizes		355	400	450	500	560	630	710	800	900	1000
Discos / Discs	Peso / Weight [kgf]	28	37	52	60	79	105	128	153	225	323
	Inércia / Inertia [kgm ²]	0,378	0,612	1,011	1,506	2,399	3,879	6,213	9,808	13,546	32,068
	D [mm]	355	400	450	500	560	630	710	800	900	1000
	b ₁ [mm]	30	30	30	30	30	30	30	30	30	30
	MF max [Nm]	1.800	2.850	4.950	4.950	7.740	11.940	17.550	17.550	29.100	40.050
	n máx. Disco / Disc Max Speed [min ⁻¹]	3.800	3.400	3.000	3.000	2.700	2.400	2.200	2.200	1.750	1.750
	d max. [mm]	60	75	95	95	110	125	140	140	160	160
	D ₁ [mm]	145	170	200	200	230	260	300	300	360	400
	D ₂ [mm]	85	110	135	135	160	180	200	200	225	225
	D ₃ [mm]	95	120	140	140	170	200	220	220	260	300
	L [mm]	180	180	220	220	220	230	230	230	275	275
	L ₁ [mm]	165	165	205	205	205	215	215	215	255	255
	L ₂ [mm]	150	150	190	190	190	200	200	200	235	235
M _A -Torque de Aperto / Tightening Torque M _A [Nm]	84	84	132	132	132	206	410	410	710	710	

Tamanhos / Sizes		200	225	250	280	315	355	400	450	500
Discos / Discs	Peso / Weight [kgf]	5,6	7,5	9,0	11,6	14,9	18,9	24,4	31,7	37,7
	Inércia / Inertia [kgm ²]	0,025	0,040	0,61	0,96	0,154	0,250	0,402	0,645	0,976
	D [mm]	200	225	250	280	315	355	400	450	500
	b ₁ [mm]	20	20	20	20	20	20	20	20	20
	MF max [Nm]	1.000	1.000	1.500	1.500	1.800	1.800	2.850	4.950	4.950
	n máx. Disco / Disc Max Speed [min ⁻¹]	5.000	5.000	4.200	4.200	3.800	3.800	3.400	3.000	3.000
	d max. [mm]	35	40	50	50	60	60	75	95	95
	D ₁ [mm]	115	120	130	130	145	145	170	200	200
	D ₂ [mm]	55	60	70	70	85	85	110	135	135
	D ₃ [mm]	60	70	80	80	95	95	120	140	140
	L [mm]	100	130	130	130	170	170	170	210	210
	L ₁ [mm]	90	120	120	120	160	160	160	200	200
	L ₂ [mm]	80	110	110	110	150	150	150	190	190
M _A -Torque de Aperto / Tightening Torque M _A [Nm]	70	70	75	75	84	84	84	132	132	